

ADAPT Colibri™

Installation - Commissioning - Maintenance

20100215

Installation

1. The commissioning box can be suspended from a ceiling and connected to a duct system. Use hanger system 1 or 2.
2. Press the ADAPT Colibri air diffuser into the outlet of the commissioning box and secure it with screws or pop rivets. Readjust the hanger rods of the commissioning box if needed, so that the air diffuser is firmly positioned against the false ceiling, or the framework of the modular suspended ceiling.
3. Remove the bottom section of the air diffuser by applying the Quick Access principle, see Figure 3.
4. Connect the air diffuser connector to the appropriate contact in the upper surface of the diffuser face plate.
5. Flip the diffuser face plate up to close it.

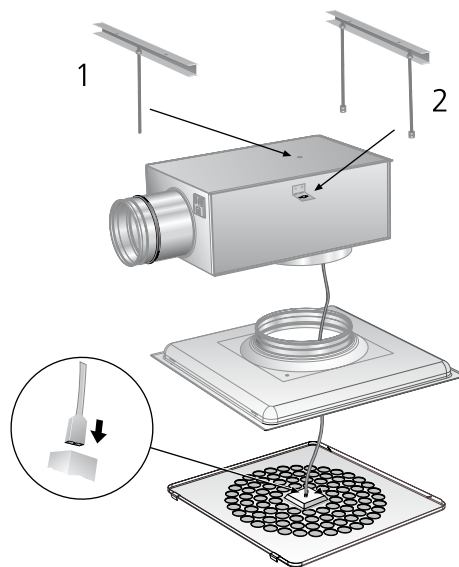

Figure 2. ADAPT Colibri, installation.

Table. Presence detector's detection area

H	A1	B1	A2	B2
2.2	4.5	4.0	2.9	2.5
2.4	4.8	4.3	3.3	2.9
2.6	5.3	4.7	3.7	3.2
2.8	5.7	5.0	4.1	3.6
3.0	6.1	5.4	4.5	4.0

Dimensions specified in meters

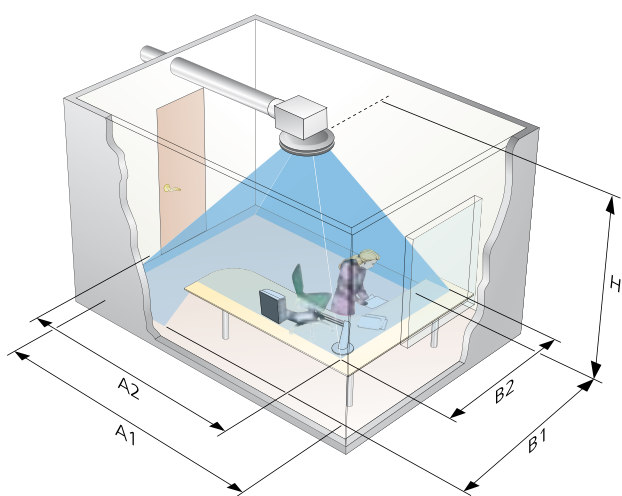
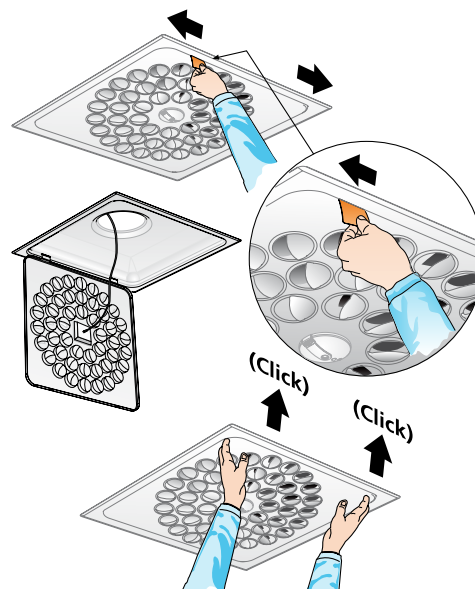

Figure 1. Presence detector's detection area.



Figur 3. Quick Access

Electrical connections.

All the connections are wired to the CONNECT Adapt junction box. From there, the Master air diffuser is connected by means of the LINK Adapt (RJ45) cable included in the delivery. The slave air diffusers, if required, are connected by means of the same type of cable to their respective slave contacts. If there are more than 2 slave air diffusers, a SPLIT Link should be used for further connection to the last slave air diffuser. See Figure 5. If SPLIT Link is used, the maximum permissible length of the LINK Adapt cable from the junction box to the last air diffuser is 15 metres. If ADAPT is to be connected up to Modbus communication, this should be done by means of the LINK Modbus (RJ12) cable. All cables and contacts are different so that they will not be confused or incorrectly connected.

Electrical data

ADAPT is supplied with power via the junction box. See the wiring diagram. It is important that cables with appropriate cross-sectional area, transformers of correct size and power supply cables of correct length are selected according to the specifications in the sizing documents available on www.swegon.com.

Supply voltage	24 V AC ±10 %
Max. power consumption	3 VA
Cable rating	0,6 A
Ambient temperature:	0 °C - +50 °C

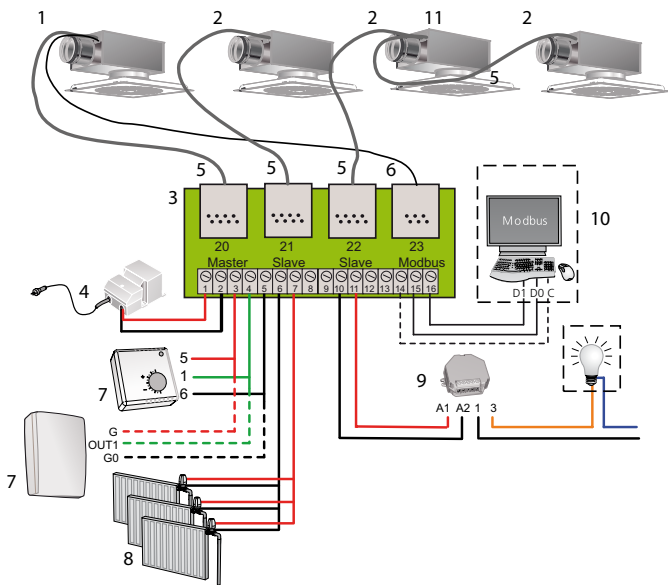

Figure 4. Wiring of Master/Slave air diffusers and accessories

1. ADAPT Master air diffuser
2. ADAPT Slave air diffusers
3. CONNECT Adapt, wiring terminals
4. 230-24 V AC Transformer
5. 5 m long LINK Adapt (RJ45 cable)
6. 5 m long LINK Modbus (RJ45 cable)
7. DETECT Quality (3 VA) or TUNE Temp (1 VA)
8. LUNA AT-2 Radiator control (max 3 valves at 6 VA)
9. Relay for lighting
10. Connection to main control system (Modbus RTU)
11. SPLIT Link

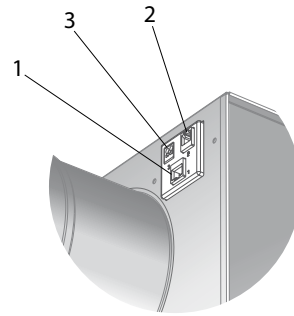

Figure 5. Air diffuser connections

1. Connection for LINK Adapt cable (RJ45)
2. Connection for the LINK Modbus cable (RJ12). Only the master air diffuser should be connected.
3. Direct 24 V connection if a junction box is not used and the air diffuser will be completely "stand alone".

Commissioning

All the ADAPT Air terminals are supplied preset to the so-called commissioning mode, which means that the air diffuser is controlled by force to the max. airflow setting. More information about the commissioning process itself can be read in the Project Manual for the WISE system and in the instructions for TUNE Adapt. When the ADAPT air diffuser is in commissioning mode, the light-emitting diode shines orange.

- Steady green LED: Normal operation, the air diffuser is operating normally.
- Flashing green LED: The air diffuser has just been energised and calibration is in progress.
- Steady red LED: The voltage (24V AC) is too low
- Flashing red LED: Internal sensor error
- Steady orange LED: The commissioning mode, max. airflow
- Flashing orange LED: Other commissioning modes and all the forced control situations of the feed-back control system.

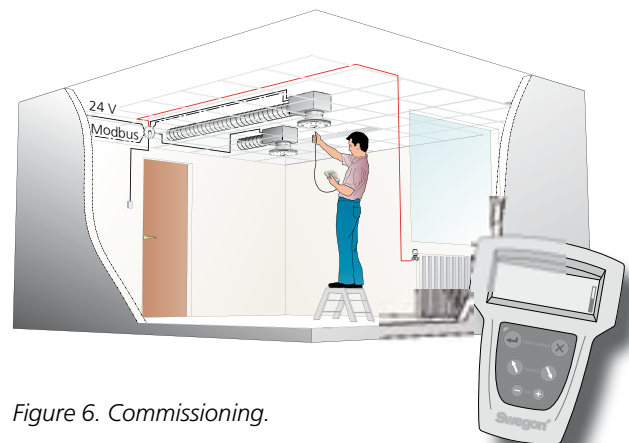

Figure 6. Commissioning.

Maintenance

The exterior surface of the ADAPT air diffusers can be cleaned whenever necessary using lukewarm water with dishwashing detergent added. Normally the best method of cleaning is vacuuming with a brush nozzle.

The duct system is accessible through the air diffuser and the commissioning box.